

Item # 83262

## USE AND CARE GUIDE

### 72" XL TROLLEY

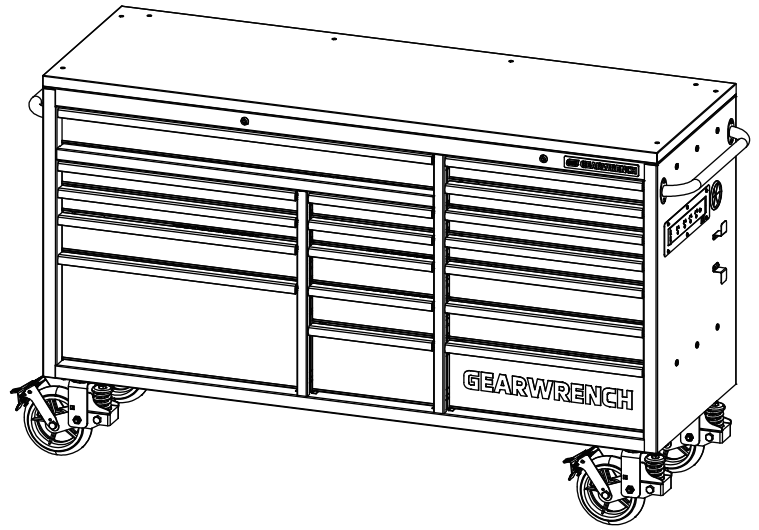

## Safety Information

1. Do not pull this unit, push it when moving.
2. Use the brakes when this product is not being moved. This prevents the product from rolling.
3. Secure this product properly before moving it with a forklift.
4. Do not tow the product with power equipment.
5. Do not alter this product in any manner. For example, do not weld external lock bars or attach electrical equipment.
6. Before locking the cabinet, ensure the drawers are completely closed in order for the lock bars to work properly.



**CAUTION:** Do not attach or mount this product to a vehicle or mobile trailers. This may cause personal injury or product damage. Mounting this product to any vehicle or mobile trailers in any manner will void warranty.



**CAUTION:** Do not stand, sit or climb on this product. You may fall which may cause personal injury or product damage.



**CAUTION:** Be careful when opening more than one drawer. The product may become unstable and tip, which may cause personal injury or product damage.



**CAUTION:** Keep the product on level surfaces. The product may become unstable and tip if stored or moved on an unlevel surface, which may cause personal injury or product damage.



**CAUTION:** Lock the drawers before moving this product. The drawers could come open and make the product unstable and tip, which may cause personal injury or product damage.



**CAUTION:** To reduce the risk of product damage or personal injury, do not exceed the specified loading capacities



**CAUTION:** Load unit starting with bottom drawers. Overloading the top of the unit may result in the product becoming unstable and creating a tipping hazard, which may cause personal injury or product damage.



**CAUTION:** Do not use the side handle as a point of leverage to lift the unit off of the ground. Handle is not intended to withstand the force of vertical lifting, and is only designed to aid in the movement of unit around on casters. Failure to adhere to this warning may cause handle to break and cause personal injury and/or product damage.

# Electrical Safety

1. Power lead plugs must match the outlet. Never modify the plug in any way. Do not use any adapter plugs with earthed (grounded) power tools. Unmodified plugs and matching outlets will reduce risk of electric shock.
2. Avoid body contact with earthed or grounded surfaces, such as pipes, radiators, ranges and refrigerators. There is an increased risk of electric shock if your body is earthed or grounded.
3. Do not expose to rain or wet conditions. Water entering a electrical products will increase the risk of electric shock.
4. Do not abuse the cord. Never use the cord for carrying, pulling or unplugging the power tool. Keep cord away from heat, oil, sharp edges or moving parts. Damaged or entangled cords increase the risk of electric shock.
5. If operating a power tool in a damp location is unavoidable, use a residual current device (RCD) protected supply. Use of an RCD reduces the risk of electric shock.
6. Do not operate powered products in explosive atmospheres, such as in the presence of flammable liquids, gases or dust. Powered products create sparks which may ignite the dust or fumes.
7. Keep children and bystanders away while operating any powered products. Distractions can cause you to lose control.

## Risk of Electric Shock

- Do Not Overload power boards by "piggy backing" plugs into one socket or by using double adaptors - all power boards have a maximum current rate.
- Do Not Plug high wattage appliances (such as toasters, kettles and heaters) into power boards - plug them directly to permanent power points instead.
- Do Not Use damaged, dirty or wet power boards. Do not expose to chemicals, oils or other liquids.
- Never use water to extinguish a fire caused by electrical equipment. Do not attempt to open the product housing.
- There are no user-serviceable parts inside this product. Do not repair the unit yourself.
- Supervise young children to ensure they do not play with the product.
- Do not expose to naked flames or other heat sources.
- Do not drop or subject the device to undue shock.
- Keep device away from magnets at all times.
- Keep away from direct sunlight. Indoor use only.
- Unplug this device during lightning storms or when unused for long periods of time.

# Package Contents

## HARDWARE INCLUDED



**NOTE:** Hardware not shown to actual size.



**NOTE:** The keys are taped to the drawer outside of the unit.

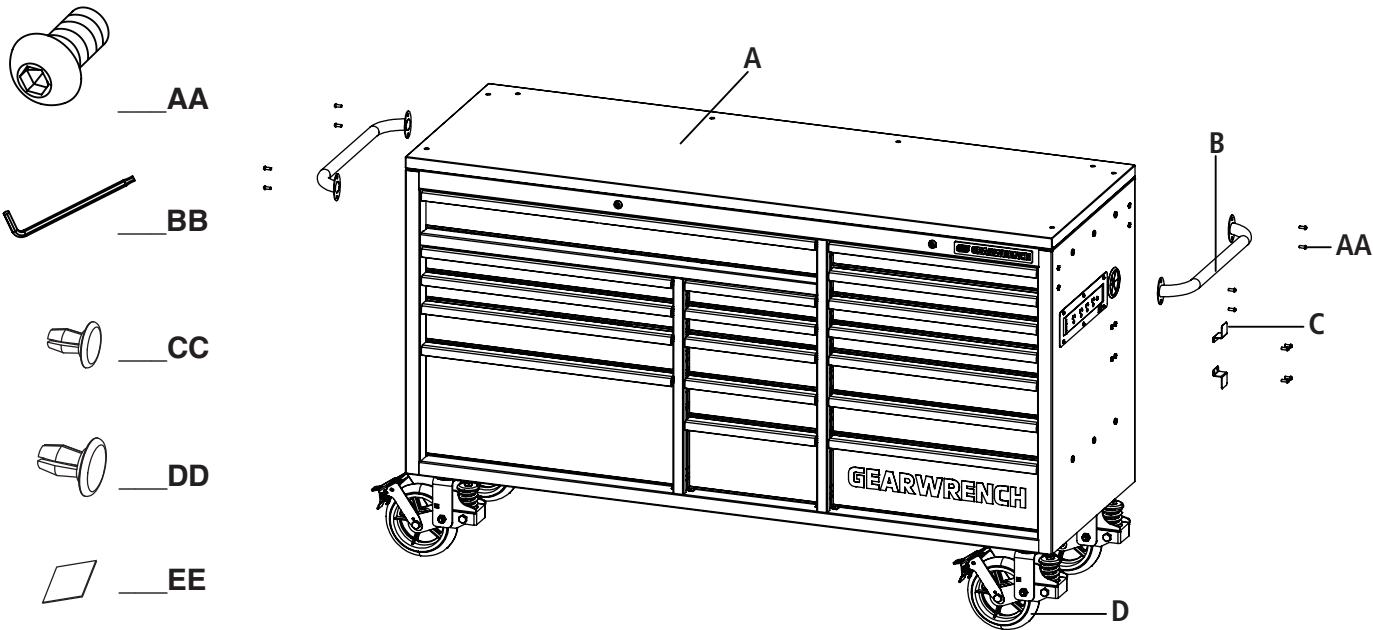

Part	Description	Quantity	Part	Description	Quantity
A	Cabinet	1	AA	M6 x 16 bolt	12
B	Handle	2	BB	Hex key	1
C	Storage hook	2	CC	Plastic plug (M6)	8
D	Swivel caster	4	DD	Plastic plug (M8)	12
			EE	Drawer liner adhesive tape	68

# Assembly



**CAUTION:** Two people are recommended for assembly.

## 1 Attaching the cabinet handles

- Position the Cabinet handle (B) over the holes on the Cabinet (A).
- Attach with the Bolts (AA) and tighten with supplied Hex key (BB).
- Repeat this process on the opposite side of Cabinet (A).



**NOTE:** The holes in the cabinet are tapped and do not require nuts.

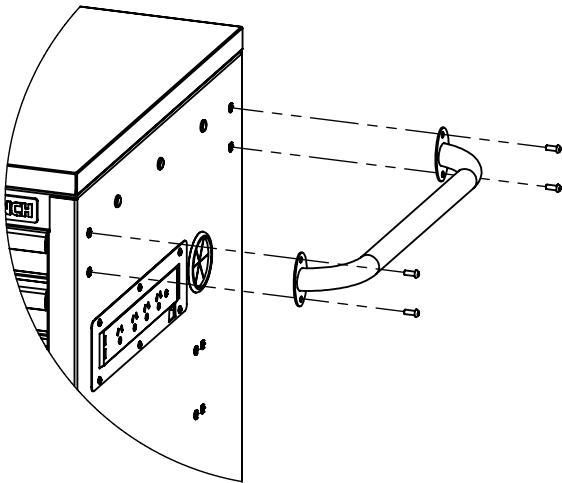

## 2 Attaching the Storage Hook

- Position the Storage hook (C) over the holes on the Cabinet (A).
- Attach Hook (C) using Bolts (AA) and tighten with supplied Hex key (BB).



**CAUTION:** Do not over tighten the bolts.

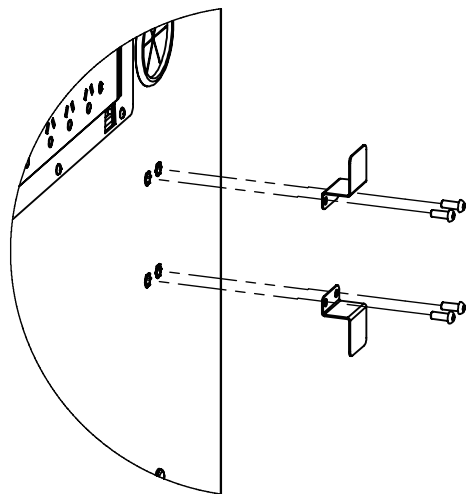

## 3 Installation of Power Cord

- Untie power cord located inside drawer.
- Gently pull cord plug through grommet.
- Wrap any loose or excess cord around the Cord Storage Hooks (C).

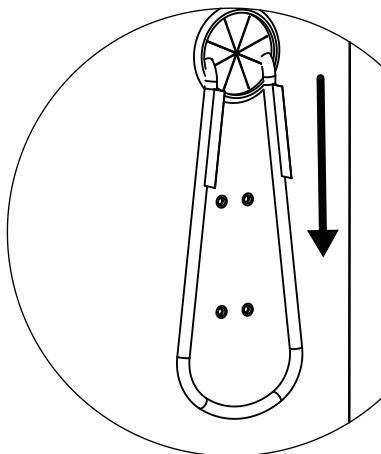

## 4 Plastic Plugs

- Insert the Plastic Plugs (CC&DD) into the remaining open holes on the side walls of the Cabinet (A) per the diagram below.

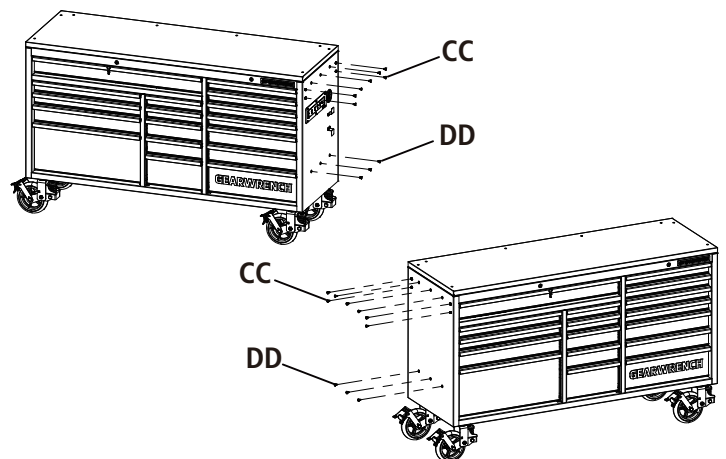

## 5 Adding drawer liner adhesive tape

- Use 4 pcs. of Drawer Liner Adhesive Tape (EE) to help secure the drawer liners in each drawer. The tape helps prevent shifting of the drawer liner during normal use.

## Operation

### 1 Removing the drawers

- Fully extend the empty drawer.
- Push up the one black release lever while pulling down on the other black release lever.
- Pull the drawer outward until it is released from the drawer slide.

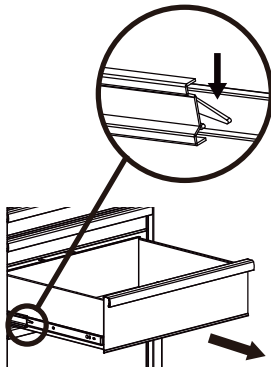

### 2 Re-inserting the drawers

- Extend the drawer slides.
- Insert the brackets on each side of the drawer into the slots in the slides, being careful that they are properly positioned.
- Once properly inserted, completely close the drawer to set the slides in their proper positions.

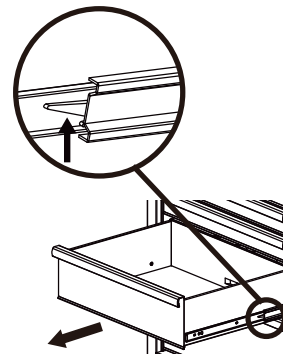

## Maintenance

### 1 Caster maintenance

- Grease the casters annually using high-quality bearing grease.

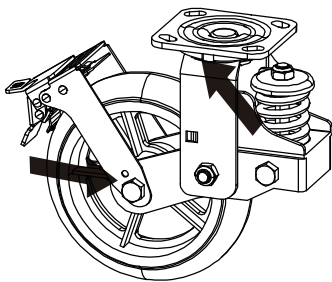

### 2 Drawer maintenance

- Lubricate the slides semi-annually.

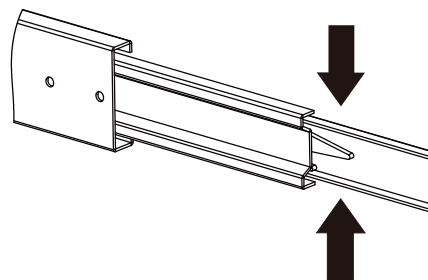

## Care and Cleaning

- Periodically clean the drawer fronts, drawer trim, and other surfaces with a mild detergent and water.
- Auto wax preserves the storage unit's luster finish and protects against scratches. Apply the wax as you would on a car.
- Remove grease and oil with a standard nonflammable cleaning fluid.

**For damaged or missing parts, please call 02 6021 6666.**